

# MVE 202 DC 24



Single Phase - poles - 3000 RPM - 0 Hz  
24 Volt



Mechanical Features		Electric Features	
<b>General</b>		<b>General</b>	
Working Moment	4.17 kgcm	Nominal Voltage	Δ : 24
Unbalance	2.08 kgcm	Input Power	0.16 kW
FC	200 kg	Current A Max	Δ : 6.7 A
<b>Bearings</b>		Power factor	0
TYPE (SKF)	6301-6302 2Z	Ia/In	4
Life(h)	100% 3732	<b>Certification</b>	
	80%: 6469	ATEX II 3D Ex tD A22	T 100°
	50%: 30319	IP66	
<b>Bearing Grease</b>		Amb Temp.	-20 ≤ T°C ≤ +40
Lube Schedule (g)			
Lube Replacement (g)			
Grease Type			

## Dimensional Features (mm)

Fig. G

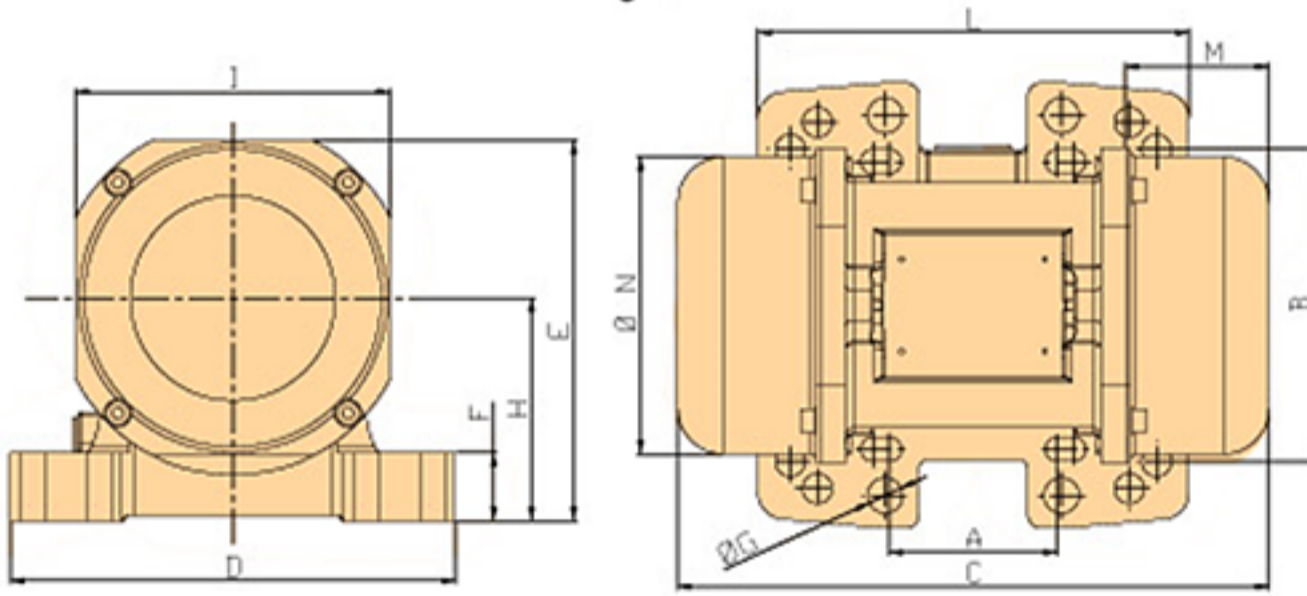

A	62-74 65 115 135
B	106 140 135 115
C	218
M	53
G	9 13 11 11
holes	4 4 4 4
D	164
E	140
F	25
H	82
I	116
L	159
N	110

### Clamping Torque (Nm)

23  
80  
45  
45

Weight(kg)	Screw	Washer	Cable Type	Cable Glандe
7.2	M8 M12 M10 M10	8.4 x 16 13 x 24 10.5x20 10.5x20	2Gx1.5	M16x1,5